



HX1302/HX1402

The New Standard in Agricultural Tractors

Seamless comfort, optimal efficiency.

HX1302/HX1402

The HX Series has been innovated to not only improve the performance of the tractor but also the convenience of operators to enhance work productivity. Optimal driving comfort, convenience and smart operability are provided, allowing operators to work comfortably and efficiently, even during long hours of work.



HX1302

HX1402

01 Work Comfortably

- Cabin suspension absorbs cabin vibration.
- Broad, rotatable air suspension seat.
- Hot and cold storage box with wireless mobile phone charging. **Option**



03 Work Variety

- Two powerful engines: 130Hp and 140Hp.
- 4,410kg-f lifting force enables heavier equipment to be attached.
- Heavy weight can be attached. **Option** 50kg x 14EA = 700kg
- Various types of rear hydraulics can be applied to use various equipment.

02 Work Longer

- 230ℓ capacity fuel tank.
- 10 LED lights brighten all 4 corners. **Option** 2 side LED lights.
- Auxiliary interior light.



04 Work Easier and Faster

- Turn-up/back-up feature that automatically lifts the implements upon rotation or reverse.
- Remote rear fender PTO & 3pt switch, allowing easy attachment and detachment of the implements from outside.
- One-hand quick coupler for convenient attachment of implement hydraulic hose.
- USB charging + power socket for using various electrical work tools.

POWER to work solution

Seeking robust power for off-road use? KIOTI's independently developed 3.8ℓ diesel engine is the optimal solution. This engine, equipped with enhanced cooling performance, low vibration, and minimal noise, delivers maximum performance while maintaining low fuel consumption, covering a power range of 95Hp to 140Hp. Furthermore, it is an eco-friendly compliant with Stage V exhaust gas regulations.

3.8L diesel engine independently developed by KIOTI

Optimized to off-road with optimal engine performance customized to work environment equipped with KIOTI's 3.8ℓ diesel engine.

- Equipped with impact-type CCV filter that doesn't require replacement.
- Applied with a 2-layer water-jacket at the cylinder head for enhanced performance.
- Ensuring an oil change interval of 500 hours, with optimized oil consumption.
- Applied with 2nd balance and offset crankshaft for low vibration and low noise.
- Stage V eco-friendly engine.

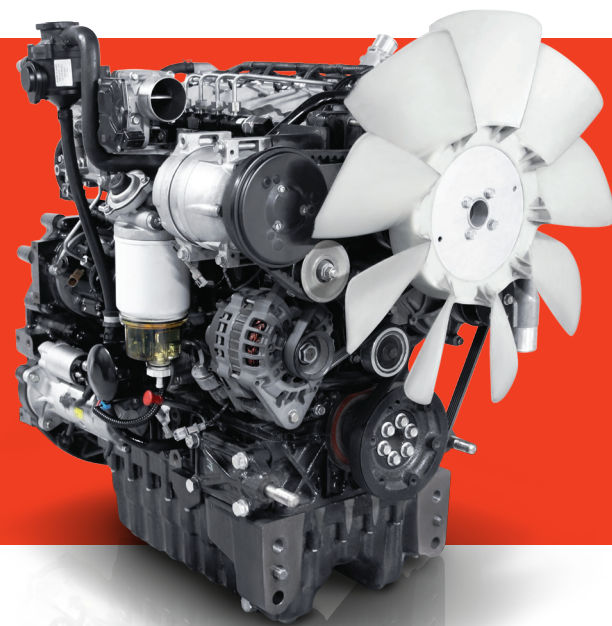

High output/High torque & low fuel consumption in its class

As a compact engine with optimized friction loss through advanced engine and gear train design, it offers a broad range of output from 95 to 140 Hp.

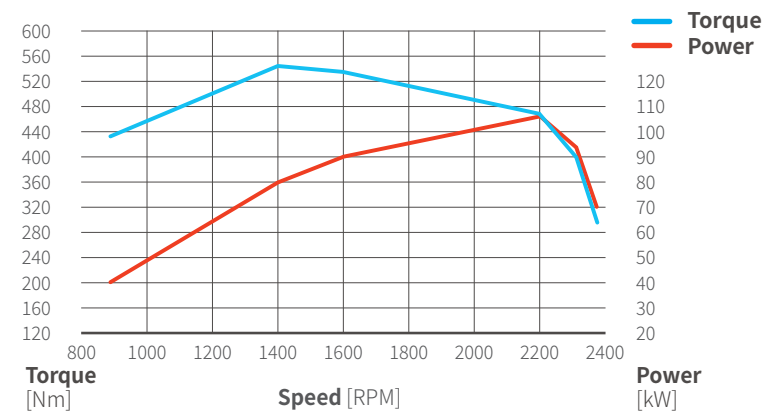

HX1402

140 Max. Power
Hp/2,200 rpm

540 Max. Torque
Nm/1,400 rpm

HX1302

130 Max. Power
Hp/2,200 rpm

530 Max. Torque
Nm/1,400 rpm

Convenient maintenance

With its easy-to-open one-piece hood structure, maintenance tasks such as oil filter and air cleaner filter replacement, oil filling, oil gauge checking, coolant inspection, as well as cleaning are convenient.



PERFORMANCE to work solution

The HX Series empowers customers to undertake diverse tasks with its exceptional performance across various working environments. It's 4,410kg.f lifting force allows various heavy implements to be attached and the front LSD exhibits powerful towing force, enabling work to be carried out regardless of the environment. In addition, up to 700kg front weight can be attached so heavy implements can be used. The 230ℓ capacity fuel tank enables extended work periods, boosting overall productivity.



4,410 kg-f lifting force

With increased 3-point hitch lifting capacity, heavy implements can be easily lifted, allowing for the attachment of various implements.



Option

Added weight

Front and rear weights can be added to provide the ability to use heavy implements.
 Front: 50kg×10ea(500kg), 50kg×14ea(700)
 Rear : 100kg×2ea(200kg)



Large-capacity fuel tank

With 230ℓ maximum capacity allows for long hours of work after one fueling.

Work can be executed more conveniently and efficiently.



Front axle LSD

With minimized wheel slip and enhanced traction, powerful traction is offered to tow implements while enabling convenient maneuvering in difficult terrains such as mud fields.



Maximum transmission in its class

With a maximum 32-speed transmission (8 speeds x 2 ranges x 2 speeds), work efficiency is maximized, delivering optimal performance in various environments.



Power shift

Shifting up to 8 gears with the push of a button. No need for the clutch pedal, significantly enhancing operational convenience.



Turn-up / back-up

Implements are lifted automatically upon reverse or rotation and the rotation of the PTO axle stops, minimizing unnecessary operations, allowing safe work.

LINK to work solution

Various implements can be easily and conveniently installed, allowing for quick and efficient work. The electronic rear 3-point hitch facilitates the installation of heavy implements, and the hydraulic top link (optional) connection is simple. The 14 hydraulic ports (2 of which are optional) allow for the attachment of a greater variety of implements for use, and the one-hand quick coupler can be used to attach and detach simultaneously. The independent PTO operates various implements conveniently and efficiently. Furthermore, the remote rear fender PTO & 3pt switch allows for external operations, and the operational situation can be checked, making it more convenient to control the implements.

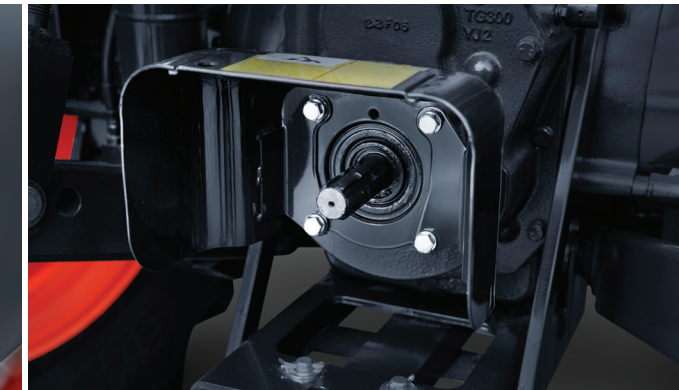
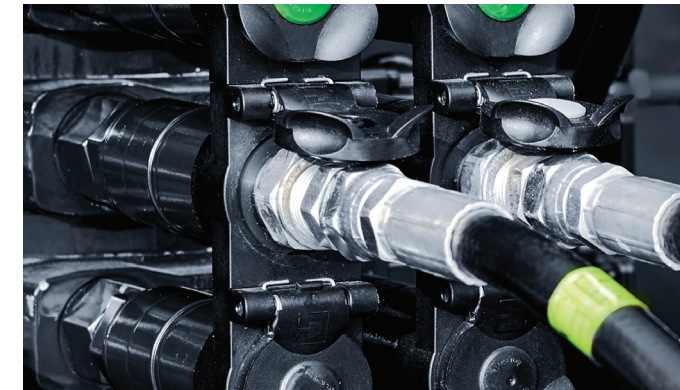

14 hydraulic ports

The maximum hydraulic ports in the tier, with 6 at the front and 8 at the rear (2 are optional) and the 3-function joystick which is essential for clamping work enable various implements to be attached.

One-hand quick coupler

It is equipped with a one-hand quick coupler so that implements can be attached and detached conveniently at once without separate maneuvering.

Electronic rear 3-point hitch

Telescopic chain link and electronic control enable the installation of implements easily.

Remote rear fender PTO switch (Left / Right)

Convenience increased by ensuring that the implements can be attached, detached and checked from outside.

PTO

Independent 3-speed PTO that can operate regardless of whether driving or stationary.

- PTO cruise function: Maintains the PTO rotation speed consistently
- AUTO PTO function: Automatically turns the PTO On/Off from the rear 3 point height that has been set
- Ground PTO function: PTO rotation speed is proportionate to the traveling speed

COMFORT to work solution

The HX Series minimizes fatigue with cabin suspensions, while the generously sized air suspension seats offer a comfortable driving experience. Furthermore, the seats can be rotated 20 degrees to the left and right, providing an unobstructed front view and ensuring visibility from multiple angles, making work much easier. The electronic armrest, combined with a cold and hot storage box that offers wireless charging, ensures comfort for the operator.



Heated premium seat

A premium air suspension seat with a wide seating area and heating function has been adopted to provide coziness and comfort, and visibility from multiple angles can be secured through its 20° rotation function in both directions.



Auto folding auxiliary seat

Transportable with co-passengers to the workplace, enhancing boarding convenience with an automatic folding seat.



Electronic armrest

The arm rest can be moved front and back and the lever and switch can be operated conveniently for easy 3-point hitch control of the rear.



Hot and cold storage box with wireless mobile phone charging

Smart phone holder that offers wireless charging and the hot and cold storage box provided for increased convenience.

Wide View Openness

5-pillar cabin and a wide window have been implemented to minimize vision obstruction, ensuring wide front visibility for precise and safe tasks, along with a pleasant work environment.

Cabin suspension

Vibration and shock are absorbed in uneven terrains, providing comfort for operators despite long working hours, reducing fatigue.

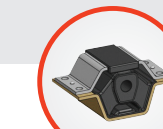

Rubber mount



Shock absorber



CONVENIENCE to work solution

Enjoy comfort throughout the day with diverse and meticulous features that been added to enhance work convenience and efficiency.



Full LED headlight

The full LED headlight, distinguished by its sleek design, enhances front visibility.



LED front work lights / rear work lights

LED lighting with long and bright range of vision enhances safety and work efficiency when working at night.



Remote rear fender 3pt switch

The remote 3-point switch located at the left/right side of the rear fender enables easy adjustments to be made when installing implements from outside.



Easy boarding and alighting

Designed to increase the safety and convenience of boarding and alighting.



Auxiliary interior lights

Separate auxiliary interior lights that shine upon the work lever offers better vision of operating levers/switches during night work as well.



Tilting and telescopic steering

The steering wheel can be adjusted according to the driver's physique and preferences. (Tilting 24 degrees, Telescopic length 50mm)



USB charging + power socket

Mobile devices can be charged, and various electrical work tools can be used, enhancing work efficiency.



Power shuttle

Conveniently shift between forward and reverse without pressing the clutch pedal, using only lever operation.



Hydraulic top link

The length of the hydraulic top link can be automatically adjusted easily, enhancing the convenience of implement attachment.



Rear wiper & Hot wire

The rear wiper and hot wire help secure a clear rear vision even during adverse weather conditions.



Radial tires

Radial tires allow for comfortable driving with low vibration, and their strong traction is optimized for towing operations. (Front: 420/70R28, Rear: 520/70R38)



Wide transparent sunroof

The wide transparent sunroof secures an anterior visual when using the loader, offering convenient operation.



4WD switch

When off, it switches to 4WD and when on, it switches to 2WD automatically, enhancing parking and driving convenience and the switch can be pressed during driving to switch to 4WD easily.



Air conditioner

Air conditioning and heating features offer pleasant and cozy working environment.



Bluetooth audio

Bluetooth stereo for hands-free calls and music playback during work allows you to enjoy long hours of work.

Front view of HX 1302 / HX 1402

- 1 Wide transparent sunroof**
Anterior visual secured during loader work.
- 2 5 pillar cabin**
Provides a panoramic view and openness.
- 3 LED front work lights (4EA)**
Clear front vision during night work.
- 4 3.8ℓ engine (stage V)**
Up to 140Hp of Outstanding power.
- 5 Easy-to-open one-piece hood**
Convenient engine maintenance.
- 6 LED Headlight**
Clear front vision while driving.
- 7 Heavy weight can be attached **Option****
Front: 50kg×10ea(500kg), 50kg×14ea(700) / Rear : 100kg×2ea(200kg)
- 8 Front axle LSD**
Easy to escape from difficult terrains such as mud fields.
- 9 32-speed transmission**
Optimal performance exhibited in various environments.
- 10 Large capacity fuel tank (230ℓ)**
Supports long hours of work compared to competitors.
- 11 LED auxiliary work lights**
Supports night work.



Rear view of HX 1302 / HX 1402

- 1 Side LED work lights (2EA) **Option****
Safe boarding and alighting during night work.
- 2 Rear LED work lights (4EA)**
Clear rear vision during night work.
- 3 Auxiliary indoor light**
Ease of switch operation during night work.
- 4 Rear wiper and hot wire**
Clear rear visibility in all weather.
- 5 Remote rear fender PTO & 3pt switch**
Convenient attachment/detachment and checking of implements from outside.
- 6 Hydraulic top link **Option****
Convenient attachment and adjustment of implements.
- 7 Rear hydraulic valve**
Use of various implements/Convenient to attach / detach with one-hand quick coupler.
- 8 Rear 3-point hitch**
Lifting capacity of 4,410kg.f.
- 9 Cabin suspension**
Presents convenient driving experience.
- 10 PTO**
Efficient implement work execution.
- 11 Radial tire**
Tires optimized to towing work.



SPECIFICATIONS

MODEL		HX1302	HX1402
ENGINE		4JTA-TP5A	
Engine gross	Hp(kw)	130.1 (97.0)	140.1 (104.5)
Fuel tank	(ℓ)	230	
TRANSMISSION			
Type		Power shift Transmission	
Speed		32Fx32R with Multi wet disc clutch	
PTO type & speed		Independent (3 speed) with Ground PTO	
Auto 4WD brake		STD.	
Differential		Front: LSD, Rear: Mechanical differential lock	
HYDRAULIC SYSTEM			
3 Point lift control type		Electronic control with remote switch at rear, Quick Cat.2	
Hydraulic flow	(lpm)	Total 121 (1 st : 74.8 / 2 nd : 46.2)	
Lift capacity		4,410kg @lift point (Max.), 3,630kg @610mm point	
External valve		F6 / R6	
DIMENSION			
Wheel base	(mm)	2,600	
Overall LEN. (w/o front weight and w/3pt hitch)	(mm)	4,518	
Overall height (CAB)	(mm)	2,906	
TIRE SIZE			
Front AG.		420 / 70R28	
Rear AG.		520 / 70R38	

*NOTE : Specifications and design are subject to change without notice.



Daedong Kioti Europe B.V.

World Trade Center Rotterdam
Beursplein 37, 3011 AA Rotterdam, The Netherlands
Tel +31(0)85 10 63 580
Website www.kioti.eu



STANDARD EQUIPMENT

- Auto 4WD
- Auto PTO
- PTO cruise
- Speedmeter
- Escort lamp control
- External hydraulic cylinder
- Joystick valve
- Front & Rear fender
- Telescopic & Dual rear view mirror
- Air conditioner / heater
- Rear window wiper
- Air suspension & Heated seat
- External 3-point lift control (button)
- Ground PTO
- 7 pin socket
- Tilting & Telescopic steering
- Instruction Seat
- Backward Alarm
- One touch floating

OPTIONAL EQUIPMENT

- Front & Rear weight
- Hydraulic valve (Detent floating / Three detent floating)
- Hot and cold storage box with wireless mobile phone charging
- Beacon
- Side working lamp
- Top Link Cylinder
- Free flow Kit



ISO 9001
NO.954596



ISO 14001
NO.771475



OHSAS 18001
NO:K033008

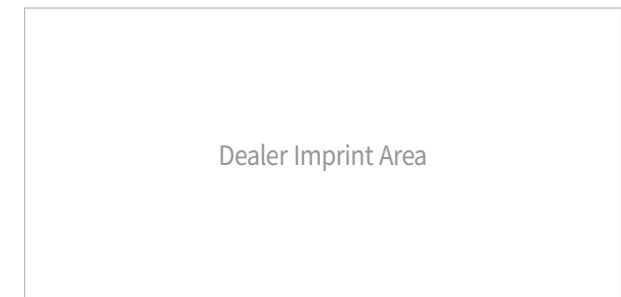

LIT-HX-ALL1